

CONSTRUCTION PLANS FOR  
MITCHELL COUNTY  
WETLAND MITIGATION BANK  
MITCHELL COUNTY, IOWA

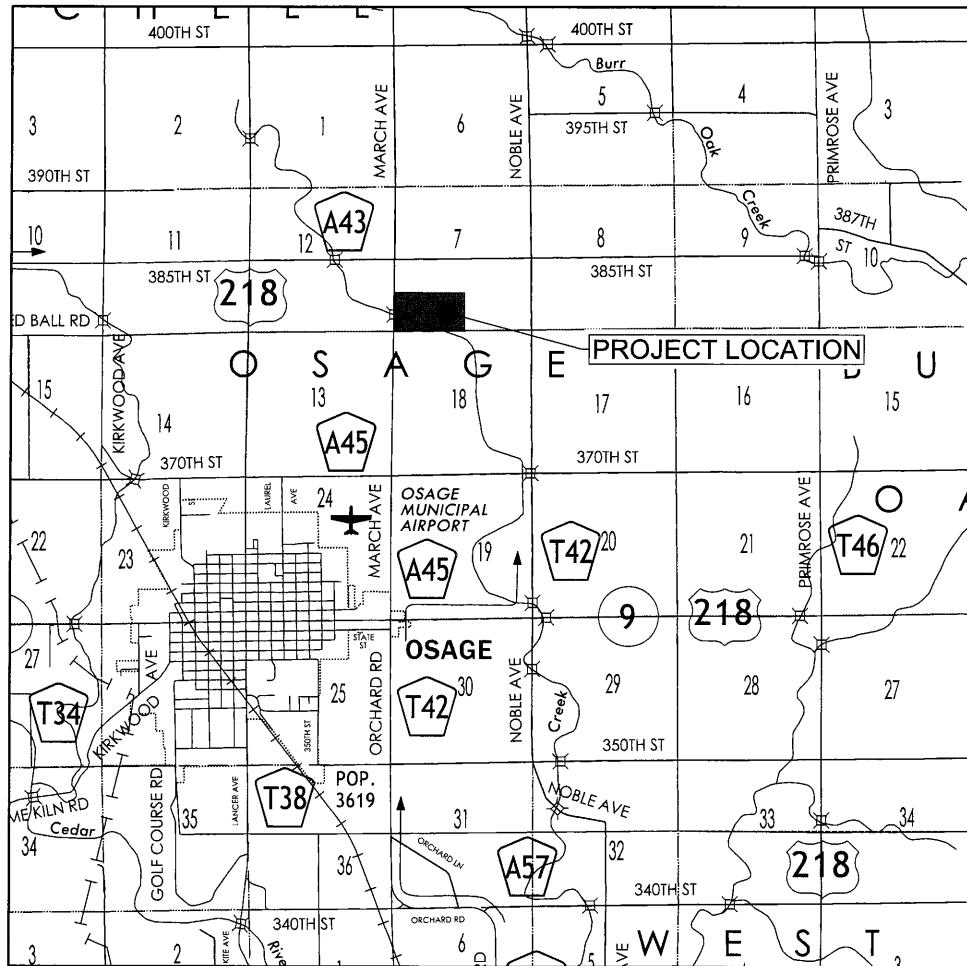
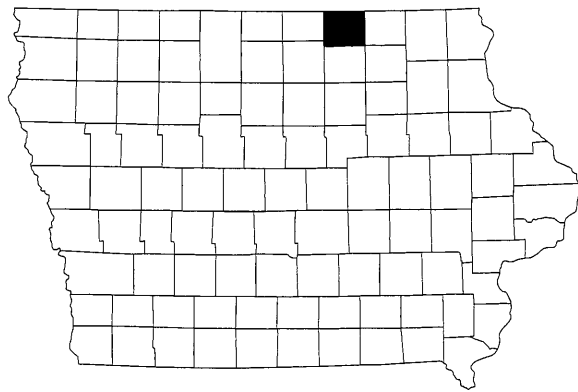

VICINITY MAP

THIS PROJECT SHALL BE CONSTRUCTED IN ACCORDANCE  
WITH THE CURRENT EDITION OF THE IOWA STATEWIDE URBAN  
DESIGN AND SPECIFICATIONS FOR PUBLIC IMPROVEMENTS

INDEX OF SHEETS

- |           |                                |
|-----------|--------------------------------|
| A.01      | TITLE SHEET                    |
| A.02      | LEGEND AND GENERAL INFORMATION |
| A.03      | GENERAL NOTES                  |
| B.01      | DETAILS                        |
| C.01      | QUANTITIES AND TABULATIONS     |
| D.01      | GRADING SITE PLAN              |
| EC.01     | POLLUTION PROTECTION NOTES     |
| EC.02     | POLLUTION PROTECTION PLAN      |
| G.01      | SURVEY CONTROL                 |
| S.01-S.02 | SEEDING PLAN                   |

Lee Allen Gourley, P.E.  
License Number P24471  
My License Renewal Date is December 31, 2023

I hereby certify that this engineering document was prepared by me or under my direct personal supervision and that I am a duly licensed Professional Engineer under the laws of the State of Iowa.

*Lee Allen Gourley* 8/4/22  
Lee Allen Gourley, P.E. Date  
License Number P24471  
My License Renewal Date is December 31, 2023

Pages or sheets covered by this seal:  
ALL SHEETS

MITCHELL COUNTY WETLAND MITIGATION BANK

TITLE SHEET

MITCHELL COUNTY, IOWA

SNYDER & ASSOCIATES, INC.



Project No: 121.0224.01

Sheet A.01

4	REVISED GRADING	4-26-22
3	PRELIMINARY PLANS	3-29-22
2	FINALIZE BUFFER AREAS	3-21-22
1	REVISIONS FOR FINAL SUBMITTAL	3-7-22
MARK	REVISION	DATE
Engineer: LAG	Checked By: CHKD	Scale: 1" =
Technician: LGM	Date: 11-10-21	T-R-S: 98N-16W-07
Project No: 121.0224.01		
Sheet A.01		

### LEGEND

## FEATURES

Section Corner  
1/2" Rebar, Cap # 11579  
(Unless Otherwise Noted)  
ROW Marker  
ROW Rail  
Control Point  
Bench Mark  
Platted Distance  
Measured Bearing & Distance  
Recorded As  
Deed Distance  
Calculated Distance  
Minimum Protection Elevation  
Centerline  
Section Line  
1/4 Section Line  
1/4 1/4 Section Line  
Easement Line

## FEATURES

Spot Elevation  
Contour Elevation  
Fence (Barbed, Field, Hog)  
Fence (Chain Link)  
Fence (Wood)  
Fence (Silt)  
Tree Line  
Tree Stump  
  
Deciduous Tree \ Shrub  
  
Coniferous Tree \ Shrub  
  
Communication  
Overhead Communication  
Fiber Optic  
Underground Electric  
Overhead Electric  
Gas Main with Size  
High Pressure Gas Main with  
Water Main with Size  
Sanitary Sewer with Size  
Dust Bank  
Test Hole Location for SUE w

(\*) Denotes the survey quality service level for utilities

Sanitary Manhole

- Storm Sewer with Size
- Storm Manhole
- Single Storm Sewer Intake
- Double Storm Sewer Intake
- Fire Hydrant
- Fire Hydrant on Building
- Water Main Valve
- Water Service Valve
- Well
- Utility Pole
- Guy Anchor
- Utility Pole with Light
- Utility Pole with Transformer
- Street Light
- Yard Light
- Electric Box
- Electric Transformer
- Traffic Sign
- Communication Pedestal
- Communication Manhole
- Communication Handhole
- Fiber Optic Manhole
- Fiber Optic Handhole
- Gas Valve
- Gas Manhole
- Gas Apparatus
- Fence Post or Guard Post
- Underground Storage Tank
- Above Ground Storage Tank
- Sign
- Satellite Dish
- Mailbox
- Sprinkler Head
- Irrigation Control Valve
- Soil Boring

Elevation

Section Number  
Drawing Number











### Removal Items

FOUND

▲  
●  
■  
⚡  
⊖CP  
⊙  
P  
M  
R  
D  
C  
MPE

EXISTING

X 1225 25  
1225  
X  
//  
○  
○

— C(\*) —  
— OC(\*) —  
— FO(\*) —  
— E(\*) —  
— OE(\*) —  
— G(\*) —  
— HPG(\*) —  
— W(\*) —  
— S(\*) —  
— DUCT(\*) —

⌘

level for utilities

[illegible]

SET

△  
○  
□  
⊥

PROPOSED

X 1225.25  
1225  
X  
//  
O

C  
OC  
FO  
E  
OE  
G  
HPG  
W  
S  
DUCT

 **Prohibited**

EL: 1225.25

## UTILITY QUALITY SERVICE LEVELS

QUALITY LEVELS OF UTILITIES ARE SHOWN IN THE PARENTHESES WITH THE UTILITY TYPE AND WHEN APPLICABLE, SIZE. THE QUALITY LEVELS ARE BASED ON THE CI / ASCE 38-02 STANDARD.

QUALITY LEVEL (D) INFORMATION IS DERIVED FROM EXISTING UTILITY RECORDS OR ORAL RECOLLECTIONS.

QUALITY LEVEL (C) INFORMATION IS OBTAINED BY SURVEYING AND PLOTTING VISIBLE ABOVE-GROUND UTILITY FEATURES AND USING PROFESSIONAL JUDGMENT IN CORRELATING THIS INFORMATION WITH QUALITY D INFORMATION.

QUALITY LEVEL (B) INFORMATION IS OBTAINED THROUGH THE APPLICATION OF APPROPRIATE SURFACE GEOPHYSICAL METHODS TO DETERMINE THE EXISTENCE AND APPROXIMATE HORIZONTAL POSITION OF SUBSURFACE UTILITIES.

QUALITY LEVEL (A) IS HORIZONTAL AND VERTICAL POSITION OF UNDERGROUND UTILITIES OBTAINED BY ACTUAL EXPOSURE OR VERIFICATION OF PREVIOUSLY EXPOSED SUBSURFACE UTILITIES, AS WELL AS THE TYPE, SIZE, CONDITION, MATERIAL, AND OTHER CHARACTERISTICS.

## UTILITY WARNING

THE UTILITIES SHOWN HAVE BEEN LOCATED FROM FIELD SURVEY INFORMATION AND/OR RECORDS OBTAINED. THE SURVEYOR MAKES NO GUARANTEE THAT THE UTILITIES OR SUBSURFACE FEATURES SHOWN COMPRISE ALL SUCH ITEMS IN THE AREA, EITHER IN SERVICE OR ABANDONED. THE SURVEYOR FURTHER DOES NOT WARRANT THAT THE UTILITIES OR SUBSURFACE FEATURES SHOWN ARE IN THE EXACT LOCATION INDICATED EXCEPT WHERE NOTED AS QUALITY LEVEL A.

### UTILITY CONTACT INFORMATION

UTILITY CONTACT FOR MAPPING INFORMATION SHOWN AS RECEIVED FROM THE IOWA ONE CALL DESIGN REQUEST SYSTEM, TICKET NUMBER \_\_\_\_\_.

NO ONE CALL WAS REQUESTED FOR THIS PROJECT.  
NO UTILITIES ARE ANTICIPATED ON THIS SITE. CONTRACTOR TO CONTACT IOWA  
ONE CALL FOR LOCATES PRIOR TO BEGINNING CONSTRUCTION.



Project No: 121.0224.01

Sheet A.02

**MITCHELL COUNTY WETLAND MITIGATION BANK**

## LEGEND AND GENERAL INFORMATION

**MITCHELL COUNTY, IOWA**

**SNYDER & ASSOCIATES, INC.**

2727 S.W. SNYDER BLVD  
ANKENY, IOWA 50023  
515-954-2020 | [www.snyder-associates.com](http://www.snyder-associates.com)

24.01

Sheet A.02

4	REVISED GRADING	4-26-22
3	PRELIMINARY PLANS	3-29-22
2	FINALIZE BUFFER AREAS	3-21-22
1	REVISIONS FOR FINAL SUBMITTAL	3-7-22
MARK	REVISION	DATE
Engineer: LAG	Checked By: CHKD	Scale: 1" =
Technician: LGM	Date: 11-10-21	T-R-S: 98N-16W-07

## GENERAL NOTES

1. NOTIFY OWNER AND ENGINEER AT LEAST 48 HOURS PRIOR TO STARTING CONSTRUCTION.
2. COMPLETE ALL CONSTRUCTION IN ACCORDANCE WITH CURRENT EDITION OF IOWA STATEWIDE URBAN STANDARD SPECIFICATIONS FOR PUBLIC IMPROVEMENTS 2022 EDITION AND PLANS AND SPECIFICATIONS FOR THIS PROJECT.
3. LOCATION OF EXISTING UNDERGROUND FACILITIES, STRUCTURES AND UTILITIES SHOWN ARE FROM AVAILABLE SURVEYS AND RECORDS. THESE LOCATIONS SHOULD BE CONSIDERED AS APPROXIMATE ONLY, WITH POSSIBILITY THAT OTHER UTILITIES OR UNDERGROUND FEATURES MAY EXIST. DETERMINE THE EXACT LOCATION OF ALL EXISTING UTILITIES WITHIN CONSTRUCTION LIMITS.
4. NOTIFY UTILITY COMPANIES PRIOR TO COMMENCING WORK. AVOID DAMAGE TO UTILITIES AND UNDERGROUND FEATURES DURING CONSTRUCTION. REPAIR ANY DAMAGE CAUSED BY CONSTRUCTION OPERATIONS AT CONTRACTOR'S EXPENSE.
5. COORDINATE CONSTRUCTION OPERATIONS AND COOPERATE WITH UTILITY COMPANIES WITH RESPECT TO RELOCATING ANY CONFLICTING FACILITIES. COSTS FOR LOCATING EXISTING UTILITIES, COORDINATING RELOCATION WORK, PROVIDING TEMPORARY SUPPORTS, AND STAGING CONSTRUCTION TO ACCOMMODATE THE RELOCATION OF UTILITIES IS INCIDENTAL TO CONSTRUCTION.
6. PROVIDE TEMPORARY SUPPORT FOR EXISTING UTILITY LINES THAT ARE ENCOUNTERED DURING CONSTRUCTION UNTIL BACKFILLING IS COMPLETED.
7. LIMIT GRADING AND CONSTRUCTION OPERATIONS TO THE MINIMUM REQUIRED TO COMPLETE THE PROJECT.
8. COORDINATE THE CONSTRUCTION TO MINIMIZE THE DISRUPTIONS TO THE ADJACENT PROPERTIES. ANY AREAS DISTURBED BY CONSTRUCTION OUTSIDE OF THE CONSTRUCTION LIMITS SHALL BE REPAIRED AND RESTORED AT THE CONTRACTOR'S EXPENSE.
9. DO NOT RESTRICT DRAINAGE CHANNELS AND PROTECT ALL EXISTING DRAINAGE STRUCTURES. CONTRACTOR FULLY LIABLE FOR ALL DAMAGES TO PUBLIC OR PRIVATE PROPERTY CAUSED BY THEIR ACTION OR INACTION IN THE HANDLING OF STORM WATER FLOWS DURING CONSTRUCTION. ANY EXTRA GRADING WORK NEEDED TO MAINTAIN POSITIVE DRAINAGE WITHIN THE CONSTRUCTION LIMITS IS INCIDENTAL TO CONSTRUCTION.
10. REPAIR ALL FIELD/DRAIN TILES THAT ARE ENCOUNTERED DURING CONSTRUCTION AS SPECIFIED. RECORD THE EXISTING TYPE, SIZE, LOCATION AND DEPTH OF ALL FIELD/DRAIN TILES ENCOUNTERED AND REPAIRED DURING CONSTRUCTION (INCIDENTAL). PROVIDE DATA TO THE ENGINEER FOR INCORPORATION INTO THE RECORD DRAWINGS.
11. PROTECT AND KEEP DEBRIS DEPOSITED BY THE CONSTRUCTION OFF OF ADJACENT PROPERTIES AND STREETS. REMOVE AND REPAIR ANY DAMAGE WITHOUT ADDITIONAL COMPENSATION.
12. PROTECT EXISTING TREES, SHRUBS, AND FENCES UNLESS SPECIFICALLY NOTED OR DESIGNATED OTHERWISE ON THE PLANS. REPLACE ANY ITEMS DAMAGED DURING CONSTRUCTION AT CONTRACTOR'S EXPENSE.
13. COMPLETELY REMOVE AND DISPOSE OF TREES, SHRUBS AND VEGETATION DESIGNATED FOR REMOVAL ON THE PLANS. DISPOSE OF IN ACCORDANCE WITH SPECIFICATIONS.
14. CONTRACTORS SHALL SATISFY THEMSELVES PRIOR TO SUBMISSION OF BIDS AS TO THE SOIL CONDITIONS.
15. PROTECT AND SAVE ALL PROPERTY CORNER MONUMENTS. REPLACE IF REMOVED OR DAMAGED (INCIDENTAL).
16. PROVIDE TRAFFIC CONTROL IN ACCORDANCE WITH CURRENT STATE OF IOWA APPROVED MANUAL ON UNIFORM TRAFFIC CONTROL DEVICES.
17. DO NOT STORE EQUIPMENT AND/OR MATERIALS WITHIN PUBLIC RIGHT OF WAY ON STREETS OPEN TO TRAFFIC. PROVIDE AREAS AS NEEDED FOR STORAGE OF EQUIPMENT AND/OR MATERIALS.
18. BLADING, SHAPING OR MAINTENANCE OF TEMPORARY CROSSINGS OR TEMPORARY ACCESSSES SHALL BE INCIDENTAL TO THE PROJECT.
19. REMOVE AND REPLACE, OR REPAIR ALL ROAD SURFACES AND OTHER ITEMS DAMAGED BY CONSTRUCTION ACTIVITIES TO THEIR ORIGINAL CONDITION AND/OR TO THE SATISFACTION OF THE OWNER AND ENGINEER (INCIDENTAL).
20. DISPOSAL OF WASTE AND EXCESS MATERIAL IS INCIDENTAL. STATE AND FEDERAL REQUIREMENTS. DO NOT PLACE WASTE MATERIAL WITHIN THE RIGHT-OF-WAY. KEEP CONSTRUCTION DEBRIS AND DIRT OFF OF THE ADJACENT PROPERTIES AND STREETS.
21. RECONSTRUCT ANY ROAD DITCHES DISTURBED, INCLUDING DITCH GRADES AND CROSS SECTIONS. REPLACE CULVERTS TO ORIGINAL GRADES UNLESS OTHERWISE NOTED. GRADE ALL DITCHES FOR PROPER DRAINAGE. PONDING OF WATER IS NOT ACCEPTABLE. RE-GRADE ANY DITCH WHICH DOES NOT PROPERLY DRAIN. ALL DITCH GRADING IS INCIDENTAL TO CONSTRUCTION.
22. STRIP, SALVAGE AND RESPREAD TOP 12 INCHES OF TOPSOIL IN ALL AREAS WITHIN THE CONSTRUCTION LIMITS AS PER SPECIFICATIONS, EXCEPT AREAS NOT DISTURBED BY CONSTRUCTION AND USED TO STOCKPILE THE TOPSOIL. MECHANICALLY LOOSEN A MINIMUM OF 12 INCHES OF SOIL ON ALL HAUL ROADS AND COMPACTED AREAS PRIOR TO RESPREADING OF THE TOPSOIL.

23. ASSIST ENGINEER'S FIELD REPRESENTATIVE WITH RECORD KEEPING. CONTRACTOR REQUIRED TO ATTEND FINAL AND INTERMEDIATE INSPECTIONS OF PROJECT.
24. DIMENSIONS, UTILITIES, AND GRADING ARE BASED ON AVAILABLE INFORMATION AT THE TIME OF DESIGN. DEVIATIONS MAY BE NECESSARY IN THE FIELD. REPORT ANY SUCH CHANGES OR CONFLICTS BETWEEN THE PLAN AND FIELD CONDITIONS TO PROJECT ENGINEER IMMEDIATELY.
25. IN THE EVENT OF A DISCREPANCY BETWEEN THE QUANTITY ESTIMATES AND THE DETAILED PLANS, THE DETAILED PLANS SHALL GOVERN.
26. ALL PROPOSED CONTOURS AND SPOT ELEVATIONS SHOWN ARE FINISHED GRADES UNLESS OTHERWISE NOTED.
27. ANY NECESSARY TEMPORARY STREAM CROSSINGS USE MEASURES AND METHODS, LOW WATER CROSSING THAT DON'T INCREASE FLOOD RISK UPSTREAM AND DOWNSTREAM. PRESERVE CHANNEL BOTTOM ELEVATION.

## INCIDENTAL CONTRACT ITEMS

THE FOLLOWING LIST INCLUDES MAJOR ITEMS THAT ARE INCIDENTAL TO THE PROJECT AND WILL NOT BE PAID FOR AS SEPARATE BID ITEMS. OTHER ITEMS MAY BE DESIGNATED AS INCIDENTAL UNDER CERTAIN BID ITEMS.

- CONSTRUCTION FENCING
  - CONSTRUCTION STAGING
  - COORDINATION AND COOPERATION WITH ENGINEER AND THEIR REPRESENTATIVES
  - COORDINATION AND COOPERATION WITH ADJACENT PROPERTY OWNERS
  - COORDINATION AND COOPERATION WITH OTHER CONTRACTORS
  - COORDINATION AND COOPERATION WITH UTILITY COMPANIES
  - EXCAVATION AND VERIFICATION OF EXISTING UTILITIES
- 
- FINISH GRADING
  - HANDLING STORM WATER FLOW DURING CONSTRUCTION
  - FLOW DIVERSIONS AND DEWATERING REQUIRED TO PERFORM WORK
  - DUST CONTROL
  - UNCOMPACTION OF SOILS AFFECTED BY WORK
  - OVERHAUL
  - PROTECTION OF PROPERTY CORNER MONUMENTS
  - PROTECTION OF EXISTING TREES, PLANTINGS, AND LANDSCAPING NOT REMOVED
  - PROTECTION OF EXISTING UTILITIES, SUCH AS LIGHT POLES, CULVERTS
  - PROTECTION OF EXISTING INFRASTRUCTURE, SUCH AS FENCES
  - PROTECTION OF OTHER INFRASTRUCTURE
  - REPLACEMENT OF DAMAGED PIPES, DRAIN TILES
  - SITE CLEANUP AND RESTORATION
  - DISPOSAL OF WASTE AND EXCESS MATERIAL IN ACCORDANCE TO LOCAL, STATE, AND FEDERAL REQUIREMENTS

4	REVISED GRADING	4-26-22
3	PRELIMINARY PLANS	3-29-22
2	FINALIZE BUFFER AREAS	3-29-22
1	REVISIONS FOR FINAL SUBMITTAL	3-7-22
MARK	REVISION	DATE
Engineer: LAG	Checked By: CHKD	Scale: 1" =
Technician: LGM	Date: 11-10-21	T-R-S: 88N-16W-07

Project No: 121.0224.01

Sheet A.03

**MITCHELL COUNTY WETLAND MITIGATION BANK**

## GENERAL NOTES

**MITCHELL COUNTY, IOWA**

**SNYDER & ASSOCIATES, INC.**

2727 S.W. SNYDER BLVD  
ANKENY, IOWA 50023  
515-964-2020 | [www.snyder-associates.com](http://www.snyder-associates.com)

Sheet A.03

Project No:121.0224.01



Project No: 121.0224.01

Sheet A.03

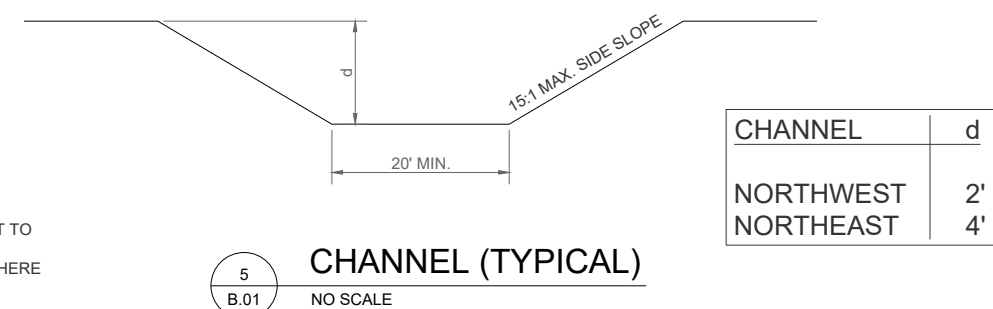
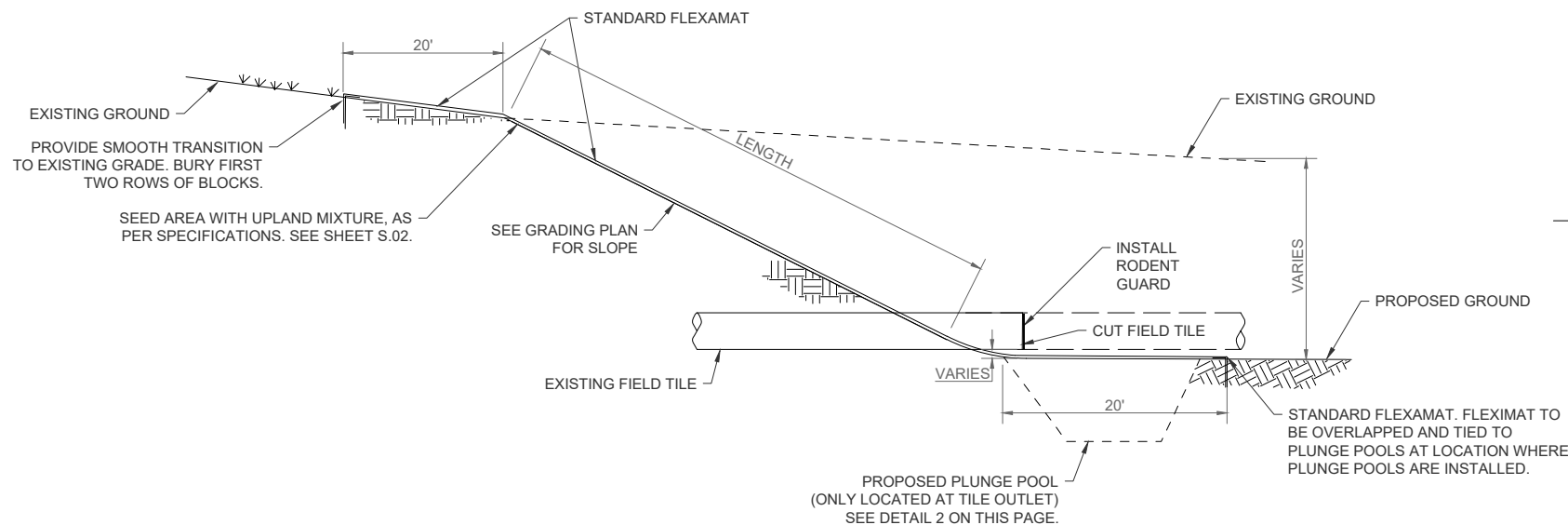
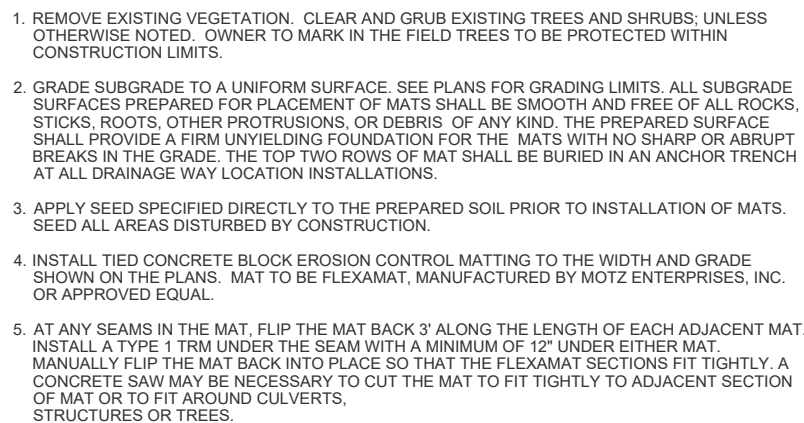
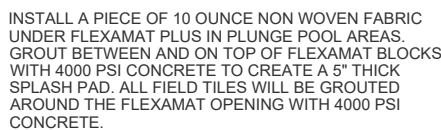
Sheet B.01

ESTIMATED PROJECT QUANTITIES					
Item No.	Item Code	Item	Unit	Quantity (Contractor)	Quantity (By Others)
1	2010-108-B-0	Clearing and Grubbing	AC	2.15	-
2	2010-108-D-1	Topsoil, On-Site	CY	34,283	-
3	2010-108-E-0	Excavation, Class 10	CY	44,065	-
4	9010-108-A-0	Conventional Seeding, Seeding, and Mulching, Type 5	AC	-	19.56
5	9010-108-A-0	Conventional Seeding, Seeding, and Mulching, Upland Mix	AC	-	38.37
6	9010-108-A-0	Conventional Seeding, Seeding, and Mulching, Wetland Mix	AC	-	16.42
7	-----	Rodent Guard, 6" Dia	EA	2	-
8	-----	Rodent Guard, 8" Dia	EA	1	-
9	-----	Rodent Guard, 10" Dia	EA	1	-
10	-----	Rodent Guard, 12" Dia	EA	2	-
11	9040-108-A-1	SWPPP Preparation	LS	1	-
12	9040-108-A-2	SWPPP Management	LS	-	1
13	-----	Flexamat (Plunge Pools)	SY	125	-
14	-----	Flexamat (Slopes)	SY	1,663	-
15	9040-108-D-1	Linear Erosion Control Device	LF	-	5,936
16	9040-108-D-2	Linear Erosion Control Device, Removal of Device	LF	-	5,936
17	9040-108-E-0	Temporary RECP, Type 2	SY	-	1,987
18	9040-108-O-1	Stabilized Construction Entrance	TON	-	100
19	9040-108-Q-1	Erosion Control Mulching, Conventional	AC	-	57.93
20	11,020-108-A	Mobilization	LS	1	-

ESTIMATE REFERENCE INFORMATION		
Item No.	Item Code	Description
1	2010-108-B-0	CLEARING AND GRUBBING (AC) Quantity may be adjusted from 0% to 100% of Bid Quantity post bid letting by owner.
2	2010-108-D-1	TOPSOIL, ON-SITE (CY) Quantity includes stripping of soil to a depth of 12 inches from the grading area. Topsoil to be stockpiled separate from the Class 10 material. Material shall be respread to a depth of no less than 8 inches. Bidders shall determine quantities and satisfy themselves for all conditions of earthwork requirements. Quantity is calculated in Bank Cubic Yards. Item does not include material in the Clearing and Grubbing area as no excavation shall occur in this area except to remove stumps. See Sheet D.01 for Clearing and Grubbing Areas.
3	2010-108-E-0	EXCAVATION, CLASS 10 (CY) This item includes 44,065 CY of cut and 119 CY of fill with a total waste of 43,946 CY. All project quantities are estimated as Bank Cubic Yards of material.  Item includes excavation of wetland to final site grades and placement of material in a stockpile as shown on the D Sheets. Material shall be stockpiled with a maximum of 4:1 side slopes. Excavation includes but is not limited to, material excavation, transportation, and placement in the stockpile.  Bidders shall determine quantities and satisfy themselves for all conditions of earthwork requirements in the submittal of bid. Payment will be made for plan quantity and no adjustments will be made.
4	9010-108-A-0	CONVENTIONAL SEEDING, SEEDING, AND MULCHING, TYPE 5 (AC) -----
5	9010-108-B-0	Hydraulic Seeding, Seeding, and Mulching, Upland Mix (AC)
6	9010-108-B-0	Hydraulic Seeding, Seeding, and Mulching, Wetland Mix (AC)  Seeding shall include all seeded preparation and other work necessary for planting of specified seed mixes. Contractor shall provide a planting schedule and seed certifications before any planting takes place. See Table on Sheet S.01.  No fertilizer shall be required for any of the seeded areas of this project.  Seed mixes are subject to the availability of seed. Only yellow tag local ecotype species shall be used for these mitigation sites. Suitable seed substitutes shall be made at the time of construction and approved by the Engineer.  See S Sheets for mix design, application rates, and locations.
7	-----	RODENT GUARD, 6" DIA (EA)
8	-----	RODENT GUARD, 8" DIA (EA)
9	-----	RODENT GUARD, 10" DIA (EA)
10	-----	RODENT GUARD, 12" DIA (EA)  Unit price includes all time, materials, and labor required to install a rodent guard in the exposed feeder tile lines in locations where the tile is above proposed grade. Rodent guards shall be installed for all exposed tile ends. Cutting of exposed field tile and abandonment, removal, or crushing of the downstream end of tile including all labor, time, and materials are incidental to Rodent Guard installation. See D Sheets for locations.
11	9040-108-A-1	SWPPP PREPARATION (LS) Refer to D Sheets for Pollution Prevention Plan information.
12	9040-108-A-2	SWPPP MANAGEMENT (LS) Payment of Lump Sum bid item will be made as follows: 1) When 25% of the total original contract has been completed, 50% of the contract price will be paid; 2) When 50% of the original contract has been completed, 70% of the contract price will be paid; 3) When 75% of the total original contract has been completed, 90% of the contract price will be paid; 4) Upon filing of Notice of Discontinuation, 100% of the contract price will be paid.
13	-----	FLEXAMAT (Plunge Pools)(SY) Unit price includes all time, materials, excavation, and labor required to install Flexamat or approved equal to form a plunge pool. Plunge pools shall be installed at each outletted field tile. Plunge pools shall be installed per Detail (See Sheet B.01). Disposal of excess cut shall be incidental to this item. Each plunge pool shall be paid for per SY. Refer to EC Sheets for locations and details. Item includes all time, materials, and equipment required to install Flexamat or approved equal per the manufacturer's recommendations. No additional compensation shall be given to install Flexamat or approved equal per the manufacturer's recommendations. All time, materials, and labor required to install the concrete splash pad are considered incidental to this item. Geogrid and Underlayment Extensions for the flexamat shall also be considered incidental to this item. Quantity may be adjusted from 0% to 100% of Bid Quantity post bid letting by owner.
14	-----	FLEXAMAT (Slopes)(SY) Refer to EC Sheets for locations and details. Item includes all time, materials, and equipment required to install Flexamat or approved equal per the manufacturer's recommendations. No additional compensation shall be given to install Flexamat or approved equal per the manufacturer's recommendations. Quantity may be adjusted from 0% to 100% of Bid Quantity post bid letting by owner.
15	9040-108-D-1	LINEAR EROSION CONTROL DEVICE (LF)
16	9040-108-D-3	LINEAR EROSION CONTROL, REMOVAL OF DEVICE (LF) Refer to D Sheets for recommended locations. Item includes installation, maintenance, and removal of linear erosion control measure such as silt fence, filter sock, wattles or other linear erosion and sediment control devices. Linear Erosion Control Device shall be removed upon establishment of 80% of ground cover. Choice of linear control measure to be determined by site conditions, inspections, and past performance of selected measures. Materials and construction to be in accordance with Section 9040 for each selected device. Refer to Section 9040, 1.08 for measurement and payment information of each selected device.
17	9040-108-E-0	TEMPORARY RECP, TYPE 2 (SY) -----
18	9040-108-O-1	STABILIZED CONSTRUCTION ENTRANCE (TON) Quantity is estimated for bidding purposes. Removal of material, stockpiling on-site, and restoration are incidental to this item.
19	9040-108-Q-1	EROSION CONTROL MULCHING, CONVENTIONAL (AC) Includes temporary mulching of disturbed areas which will not be stabilized, seeded, or sodded within 14 days. Quantity is estimated for bidding purposes.
20	11,020-108-A	MOBILIZATION (LS) Traffic Control, if required, for trucks entering the roadway shall be incidental to this item.

4	REVISED GRADING	4-26-22
3	PRELIMINARY PLANS	3-29-22
2	FINALIZE BUFFER AREAS	3-21-22
1	REVISIONS FOR FINAL SUBMITTAL	3-7-22
MARK	REVISION	DATE BY
Engineer: LAG	Checked By: CHKD	Scale: 1" =
Technician: LGM	Date: 11-10-21	1-R-S 98N-16W-07

Project No: 121.02224.01

Sheet C-01

# BANK

**MITCHELL COUNTY, IOWA**

**SNYDER & ASSOCIATES, INC.** | 2727 S.W. SNYDER BLVD  
ANKENY, IOWA 50023  
515-964-2020 | [www.snyder-associates.com](http://www.snyder-associates.com)



Project No: 121.0224.01

Sheet C.01

Sheet C.01

#### 4.01

Project No: 121.0224.01



Project No: 121.0224.01	Sheet D.01
-------------------------	------------

## 1. POLLUTION PREVENTION AND EROSION PROTECTION

- 1.1. CODE COMPLIANCE: THE CONTRACTOR IS RESPONSIBLE FOR COMPLIANCE WITH ALL POTENTIAL POLLUTION AND SOIL EROSION CONTROL REQUIREMENTS OF THE IOWA CODE, THE IOWA DEPARTMENT OF NATURAL RESOURCES (IDNR) NPDES PERMIT, THE U.S. CLEAN WATER ACT AND ANY LOCAL ORDINANCES. THE CONTRACTOR SHALL TAKE ALL NECESSARY STEPS TO PROTECT AGAINST EROSION AND POLLUTION FROM THIS PROJECT SITE AND ALL OFF-SITE BORROW OR DEPOSIT AREAS DURING PERFORMANCE OR AS A RESULT OF PERFORMANCE.
- 1.2. DAMAGE CLAIMS: THE CONTRACTOR WILL HOLD THE OWNER AND ARCHITECT / ENGINEER HARMLESS FROM ANY AND ALL CLAIMS OF ANY TYPE WHATSOEVER RESULTING FROM DAMAGES TO ADJOINING PUBLIC OR PRIVATE PROPERTY, INCLUDING REASONABLE ATTORNEY FEES INCURRED TO OWNER. FURTHER, IF THE CONTRACTOR FAILS TO TAKE NECESSARY STEPS TO PROMPTLY REMOVE EARTH SEDIMENTATION OR DEBRIS WHICH COMES ONTO ADJOINING PUBLIC OR PRIVATE PROPERTY, THE OWNER MAY, BUT NEED NOT, REMOVE SUCH ITEMS AND DEDUCT THE COST THEREOF FROM AMOUNTS DUE TO THE CONTRACTOR.

## 2. STORM WATER DISCHARGE PERMIT

- 2.1. THIS PROJECT REQUIRES COVERAGE UNDER THE NPDES GENERAL PERMIT NO. 2 FOR STORM WATER DISCHARGES ASSOCIATED WITH CONSTRUCTION ACTIVITIES FROM THE IDNR, AS REQUIRED BY THE ENVIRONMENTAL PROTECTION AGENCY (EPA). THE GENERAL CONTRACTOR AND ALL SUBCONTRACTORS ARE RESPONSIBLE FOR COMPLIANCE WITH AND FULFILLMENT OF ALL REQUIREMENTS OF THE NPDES GENERAL PERMIT NO. 2 AS SPECIFIED IN THE CONTRACT DOCUMENTS.
- 2.2. ALL DOCUMENTS RELATED TO THE STORM WATER DISCHARGE PERMIT, INCLUDING, BUT NOT LIMITED TO, THE NOTICE OF INTENT, PROOF OF PUBLICATIONS, DISCHARGE AUTHORIZATION LETTER, CURRENT SWPPP, SITE INSPECTION LOG, AND OTHER ITEMS, SHALL BE KEPT ON SITE AT ALL TIMES AND MUST BE PRESENTED TO ANY JURISDICTIONAL AGENCIES UPON REQUEST. FAILURE TO COMPLY WITH THE NPDES PERMIT REQUIREMENTS IS A VIOLATION OF THE CLEAN WATER ACT AND THE CODE OF IOWA.
- 2.3. A "NOTICE OF DISCONTINUATION" MUST BE FILED WITH THE IDNR UPON FINAL STABILIZATION OF THE DISTURBED SITE AND REMOVAL OF ALL TEMPORARY EROSION CONTROL MEASURES. ALL PLANS, INSPECTION REPORTS, AND OTHER DOCUMENTS MUST BE RETAINED FOR A PERIOD OF THREE YEARS AFTER PROJECT COMPLETION. THE CONTRACTOR SHALL RETAIN A RECORD COPY AND PROVIDE THE ORIGINAL DOCUMENTS TO THE OWNER UPON PROJECT ACCEPTANCE AND/OR SUBMITTAL OF THE NOTICE OF DISCONTINUATION.

### 3. POLLUTION PREVENTION PLAN

- 3.1. THE STORM WATER POLLUTION PREVENTION PLAN (SWPPP) IS A SEPARATE DOCUMENT IN ADDITION TO THESE PLAN DRAWINGS. THE CONTRACTOR SHOULD REFER TO THE SWPPP FOR ADDITIONAL REQUIREMENTS AND MODIFICATIONS TO THE POLLUTION PREVENTION PLAN MADE DURING CONSTRUCTION.
- 3.2. THE SWPPP ILLUSTRATES GENERAL MEASURES AND BEST MANAGEMENT PRACTICES (BMP) FOR COMPLIANCE WITH THE PROJECT'S NPDES PERMIT COVERAGE. ALL BMP'S AND EROSION CONTROL MEASURES REQUIRED AS A RESULT OF CONSTRUCTION ACTIVITIES ARE THE RESPONSIBILITY OF THE CONTRACTOR TO IDENTIFY, NOTE AND IMPLEMENT. ADDITIONAL BMP'S FROM THOSE SHOWN ON THE PLAN MAY BE REQUIRED.
- 3.3. THE SWPPP AND SITE MAP SHOULD BE EXPEDITIOUSLY REVISED TO REFLECT CONSTRUCTION PROGRESS AND CHANGES AT THE PROJECT SITE.
- 3.4. THE CONTRACTOR IS RESPONSIBLE FOR COMPLIANCE WITH ALL REQUIREMENTS OF THE GENERAL PERMIT AND SWPPP, INCLUDING, BUT NOT LIMITED TO, THE FOLLOWING BMP'S UNLESS INFEASIBLE OR NOT APPLICABLE:
  - 3.4.1. UTILIZE OUTLET STRUCTURES THAT WITHDRAW WATER FROM THE SURFACE WHEN DISCHARGING FROM BASINS, PROVIDE AND MAINTAIN NATURAL BUFFERS AROUND SURFACE WATERS. DIRECT STORM WATER TO VEGETATED AREAS TO INCREASE SEDIMENT REMOVAL AND MAXIMIZE STORM WATER INFILTRATION, AND MINIMIZE SOIL COMPACTION.
  - 3.4.2. INSTALL PERIMETER AND FINAL SEDIMENT CONTROL MEASURES SUCH AS SILT BARRIERS, DITCH CHECKS, DIVERSION BERMS, OR SEDIMENTATION BASINS DOWNSTREAM OF SOIL DISTURBING ACTIVITIES PRIOR TO SITE CLEARING AND GRADING OPERATIONS.
  - 3.4.3. PRESERVE EXISTING VEGETATION IN AREAS NOT NEEDED FOR CONSTRUCTION AND LIMIT TO A MINIMUM THE TOTAL AREA DISTURBED BY CONSTRUCTION OPERATIONS AT ANY TIME.
  - 3.4.4. MAINTAIN ALL TEMPORARY AND PERMANENT EROSION CONTROL MEASURES IN WORKING ORDER, INCLUDING CLEANING, REPAIRING, REPLACEMENT, AND SEDIMENT REMOVAL THROUGHOUT THE PERMIT PERIOD. CLEAN OR REPLACE SILT CONTROL DEVICES WHEN THE MEASURES HAVE LOST 50% OF THEIR ORIGINAL CAPACITY.
  - 3.4.5. INSPECT THE PROJECT AREA AND CONTROL DEVICES (BY QUALIFIED PERSONNEL ASSIGNED BY THE CONTRACTOR) EVERY SEVEN CALENDAR DAYS. RECORD THE FINDINGS OF THESE INSPECTIONS AND ANY RESULTING ACTIONS IN THE SWPPP WITH A COPY SUBMITTED WEEKLY TO THE OWNER OR ENGINEER DURING CONSTRUCTION. REVISE THE SWPPP AND IMPLEMENT ANY RECOMMENDED MEASURES WITHIN 7 DAYS.

- 3.4.6. PREVENT ACCUMULATION OF EARTH AND DEBRIS FROM CONSTRUCTION ACTIVITIES ON ADJOINING PUBLIC OR PRIVATE PROPERTIES, INCLUDING STREETS, DRIVEWAYS, SIDEWALKS, DRAINAGEWAYS, OR UNDERGROUND SEWERS. REMOVE ANY ACCUMULATION OF EARTH OR DEBRIS IMMEDIATELY AND TAKE REMEDIAL ACTIONS FOR FUTURE PREVENTION.
- 3.4.7. INSTALL NECESSARY CONTROL MEASURES SUCH AS SILT BARRIERS, EROSION CONTROL MATS, MULCH, DITCH CHECKS OR RIPRAP AS SOON AS AREAS REACH THEIR FINAL GRADES AND AS CONSTRUCTION OPERATIONS PROGRESS TO ENSURE CONTINUOUS RUNOFF CONTROL. PROVIDE INLET AND OUTLET CONTROL MEASURES AS SOON AS STORM SEWERS ARE INSTALLED.
- 3.4.8. RESPREAD A MINIMUM OF 12 INCHES OF TOPSOIL (INCLUDING TOPSOIL FOUND IN SOD) ON ALL DISTURBED AREAS.
- 3.4.9. STABILIZE UNDEVELOPED, DISTURBED AREAS WITH MULCH, TEMPORARY SEED MIX, OR PERMANENT SEED MIX, IMMEDIATELY AS SOON AS POSSIBLE UPON COMPLETION OR DELAY OF GRADING OPERATIONS. INITIATE STABILIZATION MEASURES IMMEDIATELY AFTER CONSTRUCTION ACTIVITY IS FINALLY COMPLETED OR TEMPORARILY CEASED ON ANY PORTION OF THE SITE AND WHICH WILL NOT RESUME FOR A PERIOD EXCEEDING 14 CALENDAR DAYS.
- 3.4.10. COORDINATE LOCATIONS OF STAGING AREAS WITH THE OWNER AND RECORD IN THE SWPPP. UNLESS NOTED OTHERWISE, STAGING AREAS SHOULD CONTAIN THE FOLLOWING: JOB TRAILERS, FUELING / VEHICLE MAINTENANCE AREA, TEMPORARY SANITARY FACILITIES, MATERIALS STORAGE, AND CONCRETE WASHOUT FACILITY. CONTROL RUNOFF FROM STAGING AREAS WITH DIVERSION BERMS AND/OR SILT BARRIERS AND DIRECT TO A SEDIMENT BASIN OR OTHER CONTROL DEVICE WHERE POSSIBLE. CONCRETE WASHOUT MUST BE CONTAINED ONSITE.
- 3.4.11. REMOVE ALL TEMPORARY EROSION CONTROL MEASURES AND SITE WASTE PRIOR TO FILING OF THE "NOTICE OF DISCONTINUATION".

POLLUTION PREVENTION RESPONSIBILITIES				
	TASK	OWNER	ENGINEER	CONTRACTOR
1	CREATE THE INITIAL SWPPP.			X
2	PUBLISH THE PUBLIC NOTICE OF STORM WATER DISCHARGE.			X
3	FILE THE PUBLIC NOTICE OF INTENT WITH APPLICATION FEE FOR NPDES GENERAL PERMIT NO. 2 COVERAGE.			X
4	SIGN NPDES CERTIFICATION STATEMENT AS PERMITTEE OR CO-PERMITTEE.			X
5	COORDINATE CERTIFICATION OF SUBCONTRACTOR CO-PERMITTEES.			X
6	COMPLY WITH THE REQUIREMENTS OF THE GENERAL PERMIT NO.2 AND THE SWPPP.			X
7	INSTALL, MAINTAIN AND REMOVE EROSION CONTROL AND POLLUTION PREVENTION MEASURES.			X
8	WEEKLY INSPECTIONS AND CORRESPONDING RECORDS.			X
9	UPDATE AND MAINTAIN THE ONSITE SWPPP.			X
10	COOPERATE TO PROVIDE INFORMATION UNDER THE RESPONSIBILITY OF OTHERS.			X
11	SUBMIT THE NOTICE OF DISCONTINUATION.			X
12	ALL REQUIREMENTS NOT ASSIGNED TO OTHERS.			X

4	REVISED GRADING	4-26-22
3	PRELIMINARY PLANS	3-29-22
2	FINALIZE BUFFER AREAS	3-21-22
1	REVISIONS FOR FINAL SUBMITTAL	3-7-22
MARK	REVISION	BY
Engineer: LAG	Checked By: CHKD	Scale: 1" =
Technician: LGM	Date: 11-10-21	T-R-S: 98N-16W-07

Project No: 121.0224.01

Sheet EC.01

MITCHELL COUNTY WETLAND MITIGATION BANK

## POLLUTION PROTECTION NOTES

**MITCHELL COUNTY, IOWA**

**SNYDER & ASSOCIATES, INC.**

2727 S.W. SNYDER BLVD  
ANKENY, IOWA 50023  
515-964-2020 | [www.snyder-associates.com](http://www.snyder-associates.com)



Project No: 121.0224.01

Sheet EC.01

1. GEOGRID AND UNDERLAYMENT EXTENSIONS ON THE 15.5' WIDE ROLLS. INSTALL UPSTREAM ROLL OVER EXTENSION AND SECURE WITH "U" ANCHORS IN 2 FT. INCREMENTS.
2. 12" ANCHOR TRENCH AT 45° ANGLE, BACKFILL WITH COHESIVE SOILS AND COMPACT FIRMLY.

1 INSTALL SILT FENCE OR FILTER SOCK  
ALONG DOWNSTREAM BOUNDARY OF  
DISTURBED AREA (TYP).

LEGEND:



L. SILT FENCE OR FILTER SOCK

FLEXAMAT OR APPROVED  
EQUAL

TEMPORARY RECP  
TYPE 4

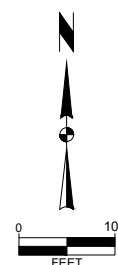

4	REVISED GRADING	4-26-22
3	PRELIMINARY PLANS	3-29-22
2	FINALIZE BUFFER AREAS	3-21-22
1	REVISIONS FOR FINAL SUBMITTAL	3-7-22
MARK	REVISION	DATE
Engineer: LAG	Checked By: CHKD	Scale: 1" =
Technician: LGM	Date: 11-10-21	T-R-S: 98N-16W-07

Project No: 121.02224.01

Sheet EC.02

## **POLLUTION PROTECTION PLAN**



Project No: 121.0224.01

Sheet EC.02

**MITCHELL COUNTY, IOWA**

**SNYDER & ASSOCIATES, INC.**

2727 S.W. SNYDER BLVD  
ANKENY, IOWA 50023  
515-964-2020 | [www.snyder-associates.com](http://www.snyder-associates.com)

Sheet EC.02



CONTROL POINTS

IOWA REGIONAL COORDINATE SYSTEM ZONE - NAD83(2011) /  
Iowa RCS Zone 2 (Mason City)NAD83(2011)(EPOCH 2010.00) IARTN  
DERIVED - US SURVEY FEET

CP1 N=9855035.65 E=12489212.04 Z=1172.84  
SET 1/2" REBAR WITH RED PLASTIC CAP, EAST SIDE OF MARCH  
AVE S., ±5' NORTH OF NO HUNTING SIGN, ±250' SOUTH OF RCBC,  
SW CORNER OF PROJECT.

CP2 N=9855035.65 E=12489213.13 Z=1170.87  
SET CUT "X" EAST EDGE OF MARCH AVE S. AT NW CORNER OF  
SITE.

CP3 N=9854711.08 E=12491554.59 Z=1169.33  
SET 1/2" REBAR WITH RED PLASTIC CAP, NE CORNER OF SITE,  
±20' SOUTH & ±20' WEST OF CORNER POST.

CP4 N=9853424.67 E=12491553.43 Z=1159.96  
SET 1/2" REBAR WITH RED PLASTIC CAP, SE CORNER OF SITE,  
±20' NORTH & ±20' WEST OF CORNER POST.

CP5 N=9853833.30 E=12490694.03 Z=1160.84  
SET 1/2" REBAR WITH RED PLASTIC CAP CENTER OF SITE.

BENCHMARKS

NORTH AMERICAN VERTICAL DATUM OF 1988 (NAVD88 -  
GEOID12A)  
IARTN DERIVED - US SURVEY FEET

BM500 ELEV=1167.36  
SET CUT "X" IN TOP OF HEADWALL, EAST SIDE OF MARCH AVE S.  
AT NORTH BARREL.

BM501 ELEV=1169.73  
SET CUT "X" IN TOP OF CONCRETE SLAB, NORTHEAST CORNER  
OF CONCRETE PAD FOR GRAIN BIN.

DATE OF SURVEY

APRIL 08, 2021

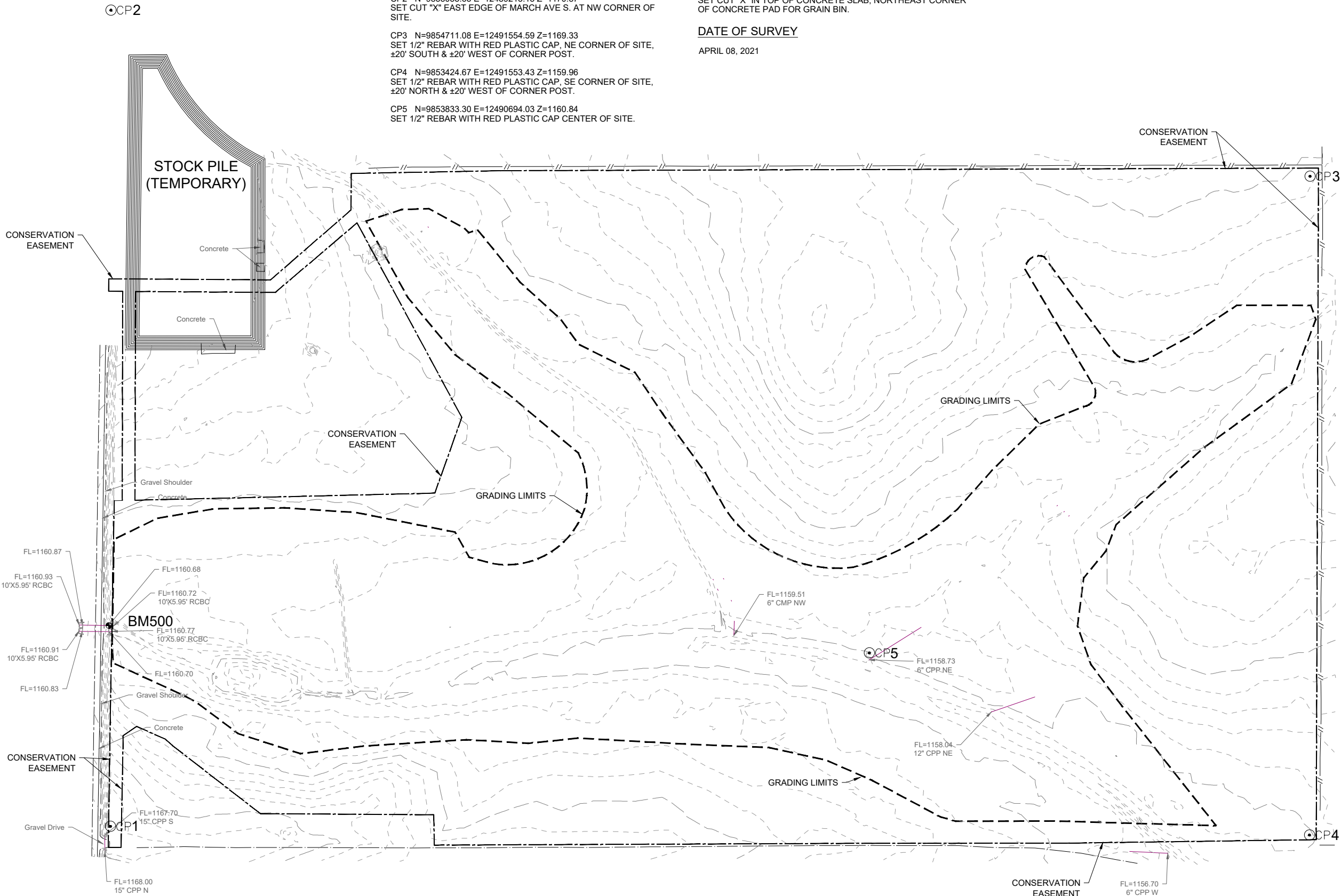

MITCHELL COUNTY WETLAND MITIGATION BANK

SURVEY CONTROL

MITCHELL COUNTY, IOWA

SNYDER & ASSOCIATES, INC. |



Project No: 121.0224.01

Sheet G.01

4	REVISED GRADING	4-26-22
3	PRELIMINARY PLANS	3-29-22
2	FINALIZE BUFFER AREAS	3-21-22
1	REVISIONS FOR FINAL SUBMITTAL	3-7-22
MARK	REVISION	DATE
Engineer: LAG	Checked By: CHKD	Scale: 1" =
Technician: LGM	Date: 11-10-21	T-R-S: 98N-16W-07
Project No: 121.0224.01		
Sheet G.01		

## SEED MIX DESIGN - HYDRIC MIX AND FLOOD PRONE WET MIX (WETLAND MIX)

<u>COMMON NAME</u>	<u>SCIENTIFIC NAME</u>	<u>RATE WT./ACRE (PLS)*</u>
GRAMINOIDS		
BIG BLUESTEM	Andropogon gerardi	1.80
PRAIRIE CORDGRASS	Spartina pectinata	1.00
VIRGINIA WILDRYE	Elymus virginicus	0.80
FOX SEDGE	Carex vulpinoidea	0.10
FOWL MANNAGRASS	Glyceria striata	1.00
BICKNELL'S SEDGE	Carex bicknellii	0.01
WOOLGRASS	Scirpus cyperinus	0.01
UPRIGHT SEDGE	Carex stricta	0.01
	Subtotal Grasses	4.73
FORBES		
BROWN-EYED SUSAN	Rudbeckia triloba	0.02
SWAMP MILKWEED	Asclepias incarnata	0.01
MOUNTAIN MINT	Pycnanthemum virginianum	0.005
RIDDELL'S GOLDENROD	Solidago riddellii	0.01
PRAIRIE BLAZING STAR	Liatris pycnostachya	0.01
PRAIRIE ROSINWEED	Silphium terebinthinaceum	0.01
FALSE DRAGONHEAD	Physostegia parviflora	0.005
CUP PLANT	Silphium perfoliatum	0.005
CULVER'S ROOT	Veronicastrum virginicum	0.007
BLUE VERVAIN	Verbena Hastata	0.03
NEW ENGLAND ASTER	Symphotrichum novae-angliae	0.01
IRONWEED	Vernonia fasciculata	0.01
SAWTOOTH SUNFLOWER	Helianthus grosseserratus	0.01
MONKEY FLOWER	Mimulus ringens	0.004
SPOTTED JOE PYE WEED	Eutrochium maculatum	0.01
GIANT ST. JOHNSWORT	Hypericum ascyron	0.01
GREAT LOBELIA	Lobelia siphilitica	0.005
CARDINAL FLOWER	Lobelia cardinalis	0.001
	Subtotal Forbs	0.172

## SEED MIX DESIGN - CP23 STANDARD MESIC (UPLAND MIX)

<u>COMMON NAME</u>	<u>SCIENTIFIC NAME</u>	<u>RATE WT./ACRE (PLS)*</u>
GRAMINOIDS		
BIG BLUESTEM	Andropogon gerardi	1.50
INDIANGRASS	Sorghastrum nutans	1.50
COMPOSITE (ROUGH) DROPSEED	Sporobolus compositus	0.71
SWITCHGRASS	Panicum virgatum	0.77
CANADA WILDRYE	Elymus canadensis	0.40
VIRGINIA WILDRYE	Elymus virginicus	0.80
PRAIRIE DROPSEED	Sporobolus heterolepis	0.01
PRAIRIE JUNEGRASS	Koeleria macrantha	0.05
FOX SEDGE	Carex vulpinoidea	0.01
	Subtotal Grasses	5.75
FORBES		
BLACK-EYED SUSAN	Rudbeckia hirta	0.55
GRAY-HEADED CONEFLOWER	Ratibida pinnata	0.10
WILD BERGAMOT	Monarda fistulosa	0.055
PRAIRIE BLAZING STAR	Liatris pycnostachya	0.01
PRAIRIE ROSINWEED	Silphium terebinthinaceum	0.01
MOUNTAIN MINT	Pycnanthemum virginianum	0.01
FALSE DRAGONHEAD	Physostegia parviflora	0.005
CUP PLANT	Silphium perfoliatum	0.005
CULVER'S ROOT	Veronicastrum virginicum	0.01
GOLDEN ALEXANDER'S	Zizia aurea	0.03
FOYGLOVE PENSTEMON	Penstemon digitalis	0.02
FEVERFEW	Tanacetum parthenium	0.02
WILD QUININE	Parthenium Integrifolium	0.01
RATTLESNAKE MASTER	Eryngium yuccifolium	0.005
TALL TICKSEED	Coreopsis tripteris	0.005
PALE INDIAN PLANTAIN	Arnoglossum atriplicifolium	0.005
PALE GENTIAN	Gentiana alba	0.01
YELLOW GENTIAN	Gentiana lutea	0.01
SWAMP MILKWEED	Asclepias incarnata	0.01
IRONWEED	Vernonia fasciculata	0.01
	Subtotal Forbs	0.89



Project No: 121.0224.01

Sheet S.02

**MITCHELL COUNTY WETLAND MITIGATION BANK**

## SEEDING PLAN

**MITCHELL COUNTY, IOWA**

**SNYDER & ASSOCIATES, INC.**

2727 S.W. SNYDER BLVD  
ANKENY, IOWA 50023  
515-964-2020 | [www.snyder-associates.com](http://www.snyder-associates.com)

4	REVISED GRADING	4-26-22
3	PRELIMINARY PLANS	3-29-22
2	FINALIZE BUFFER AREAS	3-21-22
1	REVISIONS FOR FINAL SUBMITTAL	3-7-22
MARK	REVISION	DATE
Engineer: JAG	Checked By: CHKD	Scale: 1" =
Technician: LGM	Date: 11-10-21	T-R-S: 98N-16W-07

Project No: 121.0224.01

Sheet S.02



4	REVISED GRADING	4-26-22
3	PRELIMINARY PLANS	3-29-22
2	FINALIZE BUFFER AREAS	3-21-22
1	REVISIONS FOR FINAL SUBMITTAL	3-7-22
MARK	REVISION	DATE
Engineer: LAG	Checked By: CHKD	Scale: 1" =
Technician: LGM	Date: 11-10-21	T-R-S: 98N-16W-07

**MITCHELL COUNTY WETLAND MITIGATION BANK**



Sheet S.02